

Release Notes 2.204 (24 July 2025)

Last Modified on 16/07/2025 3:52 pm AEST

ReadiNow reserves the right to update these release notes at any time.

In this article:

- Features
 - Go-Live Highlights
 - Process Engine
 - UI Feature Enhancements
 - UI Restyling
 - Charts on Nova and Classic Pages
 - Data table refinements
- Features in beta
 - AI Agent
 - AI Agent Updates
 - Query document tool
 - Agent Avatars
 - Known issues:
- Bug Fixes
 - Platform resolved issues:
 - Nova resolved issues:

Features

Go-Live Highlights

Process Engine

- **Launch of the ReadiNow Process:** The ReadiNow process engine has been officially released to production and is now available to all customers. The ReadiNow process engine offers configurable and user-friendly approach to designing and implementing business processes.

For further details see: [Process documentation](#).

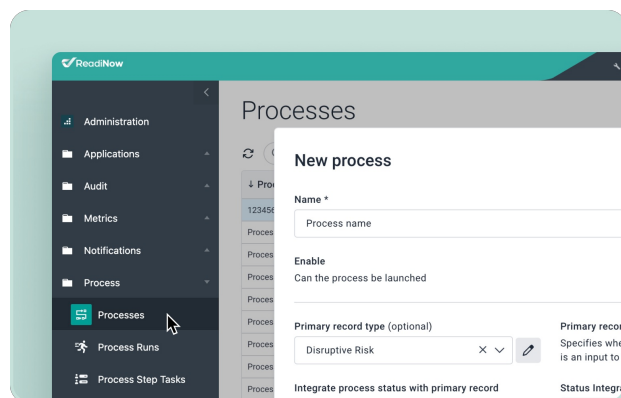

- **Enhanced visibility for workflows being run by a the ReadiNow process engine**

- **Previously:** workflows being run by a process, configured as “Wait for workflow” and executing for a long time would complete in the background. In this situation, the process will display a ‘You’re all done’ page without clear feedback on the workflow progress.
- **What’s new:** When a process runs a workflow configured as “Wait for workflow” a modal will clearly indicate that the workflow is still in progress. Users will have the option to wait until the workflow completes or leave and allow the workflow to continue in the background. This ensures a more transparent and seamless experience, and provides greater clarity and control, improving the overall user experience in Process.

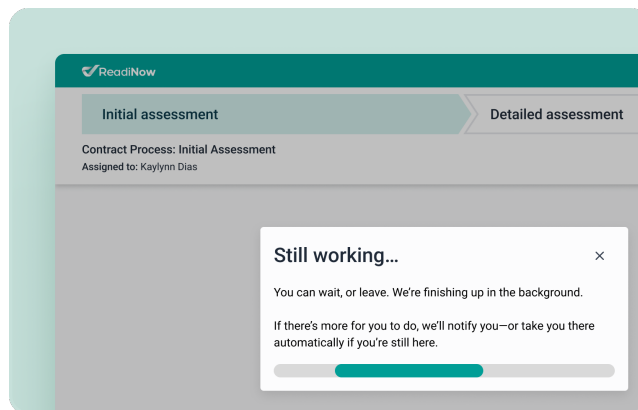

UI Feature Enhancements

UI Restyling

We've updated the look and feel across several key builders to create a cleaner, more consistent experience and better match the Nova look and feel:

- **Workflow Builder** now has a more modern interface with improved spacing, cleaner icons, and better contrast.
- **Chart Builder** has been polished for clarity, with updated layouts, and more consistent styles.
- **Report Builder** received a visual update for improved readability helping you build reports faster.

These changes are purely visual — your existing workflows, charts, and reports continue to work as before.

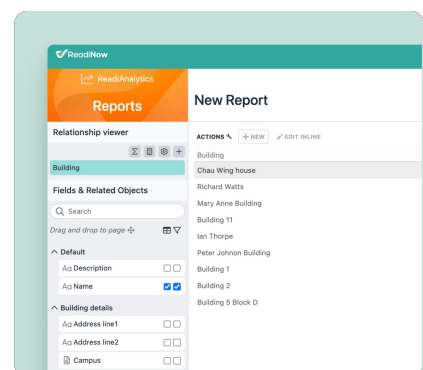
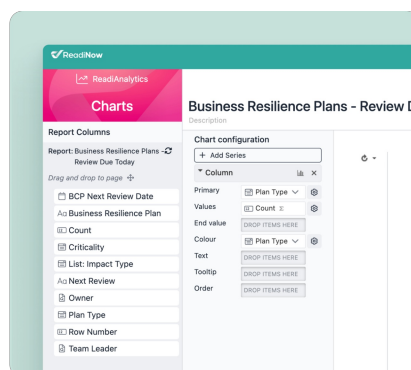
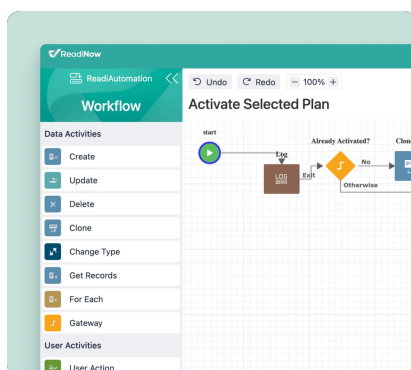

Charts on Nova and Classic Pages

- **Chart highlighting:** Chart segments now highlight when clicked, making it easier to see which one is selected. This new *active state* improves clarity during interactions. (Filtering linked components still works as before.)
- **Area charts restyling:** Area charts have received a fresh new look with clearer lines and soft color gradients, making them easier to read. Bar and column charts styling has been improved giving them a more polished and modern feel.
- **Hover highlights:** Horizontal Tree Chart will now display hover highlight for better visual feedback.



Data table refinements

- **Selected rows data in bound components:** Users can now see data from multiple selected rows displayed in bound components such as hero, charts, etc. This enhancement improves visibility and context when selecting rows, enabling better data reporting.

Features in beta

AI Agent

The **ReadiNow AI Agent** capability is an exciting advancement in intelligent automation. It introduces a highly configurable and intuitive way to design and deploy AI-driven agents that can autonomously perform tasks and make decisions. The AI Agents feature entered the beta phase in **Release 2.202** and is available to customers participating in the [feedback program](#). To trial AI Agents, please submit a support ticket to request access.

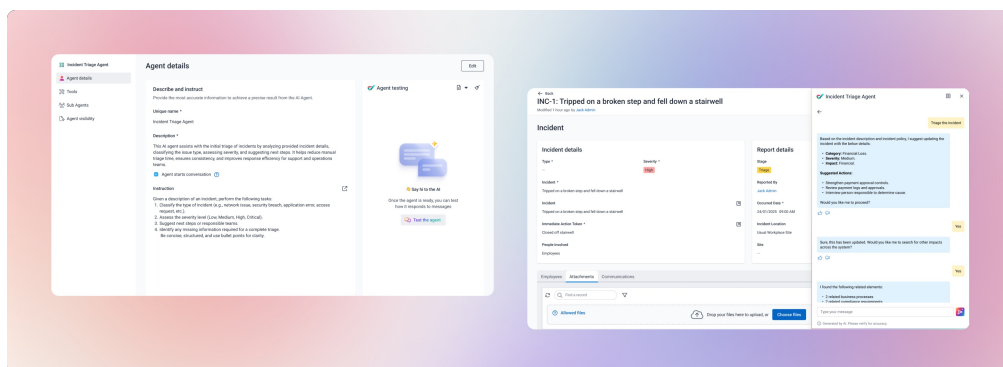

AI Agent Updates

Query document tool

Agents can now answer questions based on documents you upload — great for quick lookups and reference checks.

- **Upload a document** and ask specific questions about its content.
- **Give your document a simple name (alias)** to refer to it easily.
- **Add a short description** to help the agent know when to use it.

Ideal for queries like:

“What are the safety procedures?” or “Can contractors claim travel expenses?”

Agent Avatars

You can now assign avatars to your agents, giving them a visual identity.

Avatars appear:

- In the agent list, helping you quickly recognise who’s who.
- Next to agent responses, making interactions feel more personal.

A simple way to bring clarity and personality to your AI workspace.

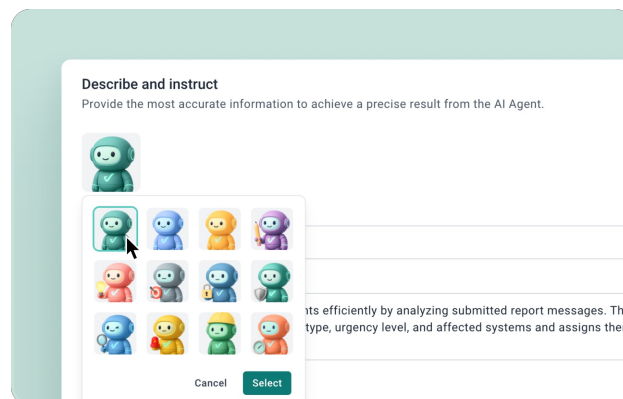

Known issues:

- Mobile support for AI Agents is currently limited and will be fully implemented in an upcoming release.

Bug Fixes

Platform resolved issues:

- Fixed an issue with report export causing auto numbers to be displayed incorrectly.

Nova resolved issues:

- Fixed an issue with component binding when binding to a person record.
- Several bugs related to charts have been fixed, including:
 - Legends with long text now display correctly with a light background.

