

Configuring the Menu structure

Last Modified on 23/01/2024 3:25 pm AEDT

The Pages section has two parts:

- Menu structure - arrangement of navigational elements within the application.
- Other pages - this is where your newly created page will show. All pages located here will be automatically hidden in the app's actual menu.

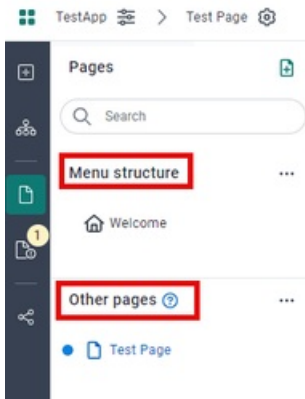

To make a page appear in the app menu, simply drag the page upward and drop it in the menu structure.

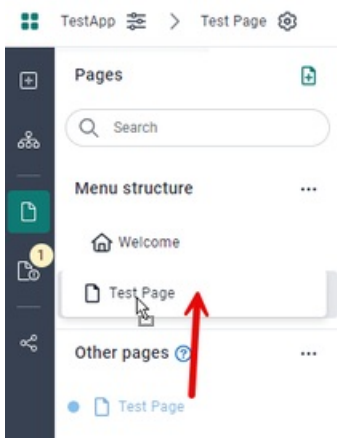

Similarly, you may rearrange the menu structure by dragging the page either up or down.

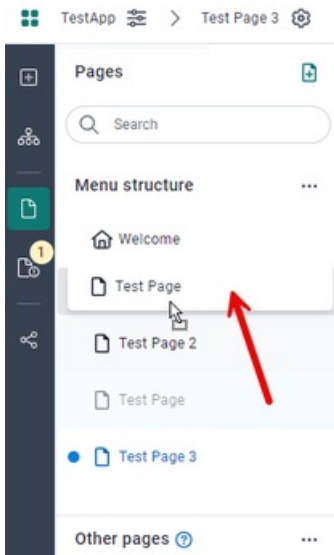

To create a hierarchy structure: 

1. Simply create a page folder by clicking on the Menu structure's options icon

...

2. Select **New folder**.

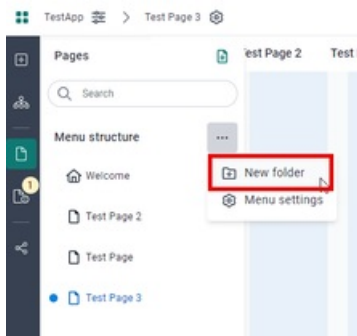

3. A new folder will be created at the bottom of the structure. To rename it, right-click the **New folder**, and select **Rename folder**.

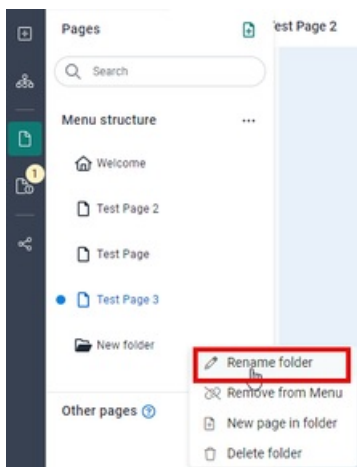

4. Enter the desired name and hit **Enter**.
5. Drag and drop the page onto the folder.

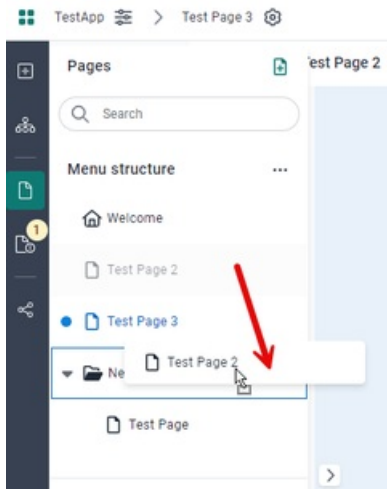

All changes are automatically saved by the app builder.